



Dx50 Mid Range Distance Sensors

Distance measurement – reliable, precise and versatile

The Dx50 product family sets new standards with HDDM technology.

SICK's many years of experience and the constant advances in distance sensor technology are reflected in the innovative HDDM (high definition distance measurement) products. HDDM is an innovative evaluation method for time-of-flight sensors. This technology enables the Dx50's high level of precision, best ambient light immunity and high measurement rate at a perfect price/performance ratio. Time-of-flight measurement allows the Dx50 product family to achieve ranges of up to 50 m with millimeter precision.

HDDM

high definition distance measurement



- + High performance
- + High precision
- + Maximum ambient light immunity
- + Maximum reliability
- + Excellent price/performance ratio



- + Widest temperature range
- + Intuitive operation
- + Robust metal housing
- + Multiple performance levels, making it easy to accommodate future changes
- + Wide range of accessories



The advantages of new HDDM technology make the Dx50 product family extremely versatile.



Range up to 50 m
Ranges of up to 50 m combined with a high-visibility laser spot mean that the list of possible applications is virtually endless.



Wide range of temperatures from -30 to +65 °C
Indoors and outdoors, summer and winter – The wide range of operating temperatures make the Dx50 product family versatile.



Maximum ambient light immunity
The Dx50 distance sensors are immune to ambient light, ensuring error-free operation and reliable measurement of distances, both indoors and outdoors.



Intuitive operation
The simple and consistent operating concept of the Dx50 distance sensors helps you reach your target at the speed of light. See the example on page 4.

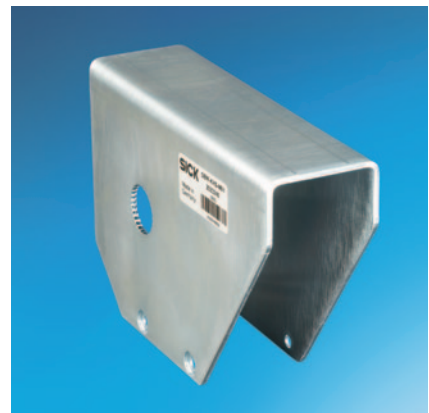

Wide range of accessories
Versatile connector technology, mounting brackets customized for the specific industry, and a variety of protective devices round off the offering.

Varied product range with an intuitive operating concept – the ideal combination for a wide range of applications.

Consistent operating concept for the entire product family

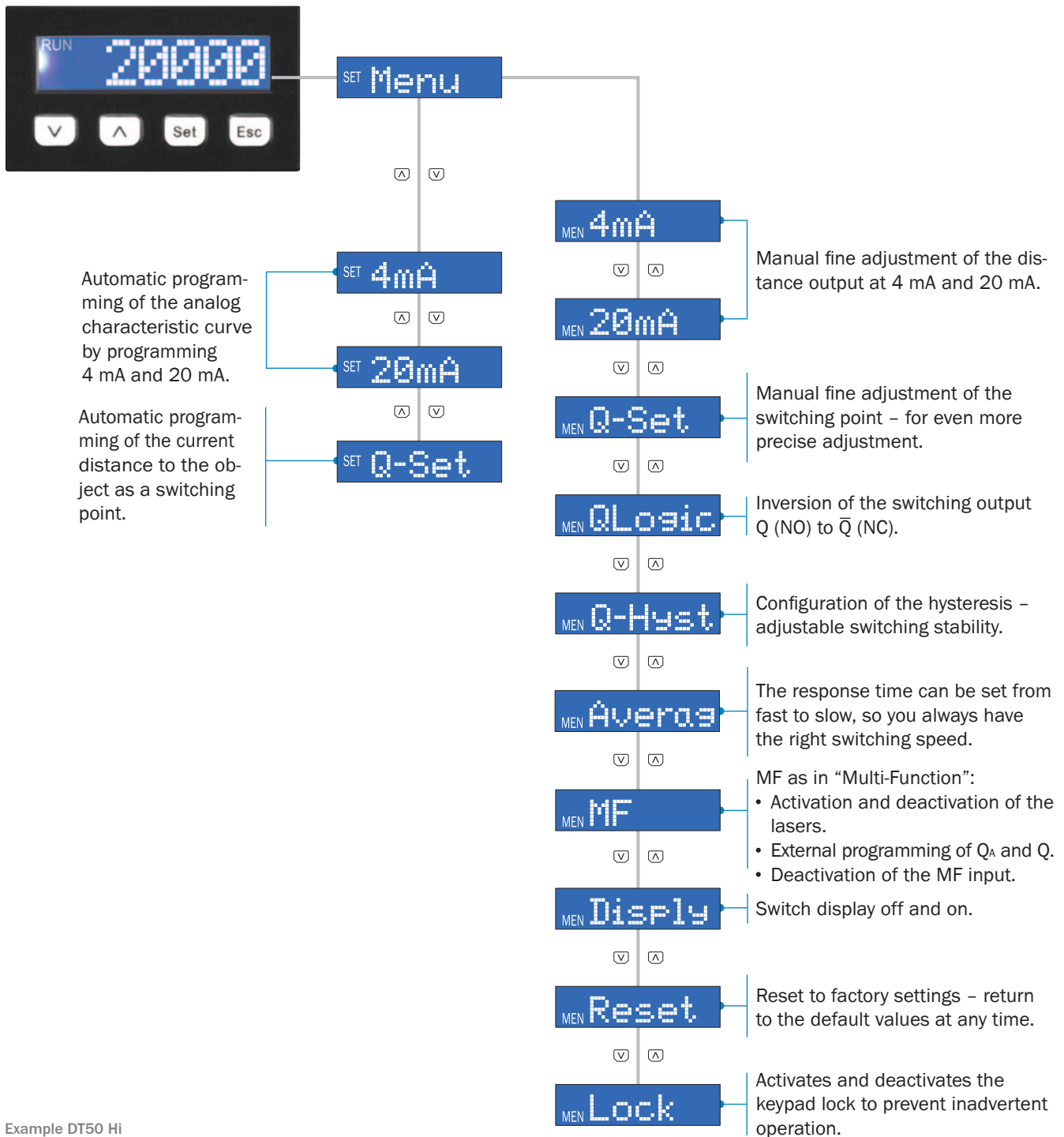

Example DT50 Hi



Laser classes 1 and 2

The Dx50 distance sensors emit a high-precision laser beam compliant with the harmless and eye-safe Class 1 and Class 2, which is more powerful and classified as safe, too.

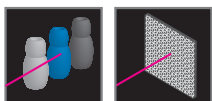

Measurement to object or reflector.

Outstanding features of the Dx50 distance sensors include minimal black/white shift when measuring to objects, impressive range when measuring to reflectors, plus reliable background suppression.

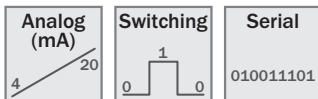

Interfaces

A variety of interfaces to fit your application requirements. The Dx50 product family provides analog, switching and serial interfaces.

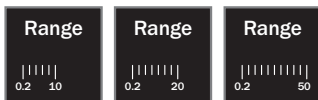

Range

The Dx50 distance sensors have maximum ranges between 10 and 50 m. Devices designed for reflector operation have the greatest ranges.



Performance (reproducibility, response time, etc.)

Overall, the measuring results of the Dx50 product family are excellent. Compared with the standard versions, the high-end versions offer even better performance.

See the table from page 6 onwards for an overview of the features of the individual products.

Typical applications

Thanks to its reliability, flexibility and tough design, the Dx50 product family is suitable for a wide range of applications, e.g. in the logistics, timber and automotive industries.



Product overview



| | DT50 | DT50 Hi | DS50 |
|--------------------------------|--|--|---|
| | The universal distance measurement solution up to 10 m | Compact size delivers exceptional performance up to 20 m | Precise detection from a distance of up to 10 m |
| Technical data overview | | | |
| Measuring object | Object (6 ... 90% remission) | | |
| Range | 200 ... 10,000 mm (at 90% remission) | 200 ... 20,000 mm (at 90% remission) 200 ... 13,000 mm (at 90% remission) | 200 ... 10,000 mm (at 90% remission) |
| Response time | 20 / 30 ms | 15 / 30 / 80 ms | 10 / 50 ms 20 / 100 ms |
| Repeatability | 5 / 2.5 mm | 3 / 2 / 1 mm | 5 / 2.5 mm |
| Accuracy | ± 10 mm | ± 7 mm | ± 10 mm |
| Interfaces | 1 x 4 ... 20 mA, 1 x switching output and 1 x multi functional input 1 x 0 ... 10 V, 1 x switching output and 1 x multi functional input | 1 x 4 ... 20 mA, 1 x switching output and 1 x multi functional input | 2 x switching outputs and 1 x multi functional input |
| Laser class | Laser class 2 Laser class 1 | | |
| At a glance | | | |
| | <ul style="list-style-type: none"> HDDM technology provides the best reliability, immunity to ambient light and price/performance ratio Reliable measurement and detection up to 10 m Wide choice of models: 4 ... 20 mA or 0 ... 10 V; PNP or NPN and laser Class 1 or 2 High switching repeatability (± 2.5 mm) Display with intuitive operating concept Tough die-cast zinc metal housing Wide operating temperature range from -30 °C to +65 °C | <ul style="list-style-type: none"> HDDM technology provides the best reliability, immunity to ambient light and price/performance ratio Most compact sensor offering up to 20 m range directly on the object Amazing repeatability up to ± 1 mm Very fast measurement and output rate with 500 Hz Analog output with 4 ... 20 mA and 1 switching output Red laser light for precise alignment Tough metal housing with LC Display | <ul style="list-style-type: none"> HDDM technology provides the best reliability, immunity to ambient light and price/performance ratio Reliable detection up to 10 m High switching repeatability (± 2.5 mm) Two discrete outputs with up to 50 Hz switching frequency Three switching modes: "Distance to Object," "Window" or "Object Between Sensor and Background" – detect any object Immune to cross talk for use with multiple sensors Superior background suppression |
| Detailed information | from page 8 | from page 12 | from page 16 |



| DL50 | DL50 Hi |
|---|--|
| Looking ahead – up to 50 m on reflector | Large positioning performance. Small housing. |
| Reflector (Diamond Grade) | |
| 200 ... 50,000 mm (on reflector) | 200 ... 50,000 mm (on reflector) |
| 15 / 30 ms | 10 / 40 / 160 ms |
| 3 / 2 mm | 0.5 / 0.3 / 0.25 mm |
| ± 7 mm | ± 3 mm |
| 1 x 4 ... 20 mA, 1 x switching output and 1 x multi functional input | 1 x RS-422, 1 x switching output and 1 x multi functional input/output |
| Laser class 1 | |
| <ul style="list-style-type: none"> • HDDM technology provides the best reliability, immunity to ambient light and price/performance ratio • Up to 50 m range on diamond grade reflector • Very good repeatability for positioning tasks – up to ± 2 mm • Fast measurement and output rate with 250 Hz • Analog output with 4 ... 20 mA and 1 switching output • Red laser light for precise alignment • Wide operating temperature range from –30 °C to +65 °C | <ul style="list-style-type: none"> • HDDM technology provides the best reliability, immunity to ambient light and price/performance ratio • Up to 50 m range on diamond grade reflector • Worlds smallest sensor for high precision positioning • Highest repeatability in its class, with ≤ ± 0.5 mm • Fast RS-422 output rate – measurement value every 2.5 ms • Immune to cross talk for use with multiple sensors • Superior background suppression |
| from page 20 | from page 24 |

The universal distance measurement solution up to 10 m



Product description

The DT50 is the entry-level model in the Dx50 product family. With a measurement range up to 10 m from the target,

the sensor offers a solution for various applications. Analog and switching outputs ensure it is easy to integrate.

At a glance

- HDDM technology provides the best reliability, immunity to ambient light and price/performance ratio
- Reliable measurement and detection up to 10 m
- Wide choice of models: 4 ... 20 mA or 0 ... 10 V; PNP or NPN and laser Class 1 or 2.
- High switching repeatability (± 2.5 mm)
- Display with intuitive operating concept
- Tough die-cast zinc metal housing
- Wide operating temperature range from -30 °C to $+65$ °C

Your benefits

- Wide measurement range allows easy and fast integration in any production environment
- Intuitive setup via display or remote teach reduces installation time and costs
- Widest temperature range allows for outdoor use without additional cooling or heating accessories
- Immune to any type of ambient light – allows for use in optically challenging environments
- Increased process stability is achieved thanks to the small black/white shift
- Metal housing withstands harsh environments, saving replacement costs
- Low investment costs and high performance guarantee quick return on investment
- Dx50 family is based on a common platform, which offers multiple performance levels, making it easy to accommodate future changes



Laser class 1



Laser class 2



Additional information

Detailed technical data 9

Ordering information 10

Dimensional drawing 11

Connection type and diagram 11

Accessories 28

Detailed technical data

Features

| | |
|---|--|
| Measuring range 90 % remission | 200 ... 10,000 mm |
| Resolution | 1 mm |
| Repeatability 6 ... 90% remission ¹⁾ | 5 / 2.5 mm ²⁾ |
| Accuracy 90 % remission | ± 10 mm |
| Response time | 20 / 30 ms ²⁾ |
| Output rate | 4 ms |
| Typ. light spot size (distance) | 15 mm x 15 mm (10 m) |
| Additional features | <ul style="list-style-type: none"> • Set moving averaging: Fast/Slow • Switching mode: Distance to object (DtO) • Teach-in of switching output • Set switching output • Set hysteresis • Invertible switching output • Teach-in of analog output • Set analog output • Invertible analog output • Multi functional input: laser off, external teach, not active • Switch off display • Reset to factory default • Lock user interface |

¹⁾ Equivalent to 1 σ .

²⁾ Dependent on the set averaging: Fast/Slow.

Interfaces

| | |
|---------------------------|------------------------|
| Outputs | See type-specific data |
| Resolution analog outputs | 16 bit |
| Switching hysteresis | 10 ... 1,000 mm |
| Inputs | See type-specific data |

Mechanics/electronics

| | |
|------------------------------------|---|
| Supply voltage V_s ³⁾ | DC 10 ... 30 V ⁴⁾ |
| Ripple ⁵⁾ | ≤ 5 V_{SS} |
| Power consumption ⁶⁾ | ≤ 2.1 W |
| Initialization time | ≤ 250 ms |
| Warm up time | ≤ 15 min |
| Typ. weight without cable | 200 g |
| Housing material | Zinc-die cast (ZNAL4CU1)/Acrylic glass (PMMA) |
| Connection type | Connector M12, 5-pin |
| Indication | LC display 2 x LED |

³⁾ Limit values, reverse-polarity protected, operation in short circuit protected network, max. 8 A.

⁴⁾ For DT50-___4: $V_s > 15$ V.

⁵⁾ May not exceed or fall short of V_s tolerances.

⁶⁾ Without load.

Ambient data

| | |
|--|--|
| Enclosure rating | IP 65 |
| Protection class | III |
| Ambient temperature | Operation: -30 ... +65 °C Storage: -40 ... +75 °C |
| Max. rel. humidity (not condensing) | ≤ 95 % |
| Typ. ambient light safety | 40 klx |
| Vibration resistance | EN 60068-2-6/-2-64 |
| Shock resistance | EN 60068-2-27/-2-29 |
| Average service life laser (MTTF at 25 °C) | 100,000 h |

Ordering information

| Light source | Measuring range (90/18/6 %) | Switching outputs (max. output current) ¹⁾ | Multi functional inputs ²⁾ | Analog outputs (max./min. load) | Model name | Part No. |
|---|--------------------------------------|--|--|------------------------------------|------------|----------|
| Laser, red, Class 2 (EN 60825-1) ³⁾ | 200 ... 10,000 / 6,500 / 4,000 mm | 1 x PNP (100 mA) ⁵⁾ | 1 x PNP ⁷⁾ | 1 x 4 ... 20 mA (≤ 300 Ω) | DT50-P1113 | 1044369 |
| | | | | 1 x 0 ... 10 V (≥ 5 kΩ) | DT50-P1114 | 1047581 |
| | | 1 x NPN (100 mA) ⁶⁾ | 1 x NPN ⁸⁾ | 1 x 4 ... 20 mA (≤ 300 Ω) | DT50-N1113 | 1047396 |
| | | | | 1 x 0 ... 10 V (≥ 5 kΩ) | DT50-N1114 | 1047582 |
| Laser, red, Class 1 (EN 60825-1) ⁴⁾ | 200 ... 10,000 / 5,000 / 2,500 mm | 1 x PNP (100 mA) ⁵⁾ | 1 x PNP ⁷⁾ | 1 x 4 ... 20 mA (≤ 300 Ω) | DT50-P1123 | 1047118 |
| | | | | 1 x 0 ... 10 V (≥ 5 kΩ) | DT50-P1124 | 1047616 |
| | | 1 x NPN (100 mA) ⁶⁾ | 1 x NPN ⁸⁾ | 1 x 4 ... 20 mA (≤ 300 Ω) | DT50-N1123 | 1047397 |
| | | | | 1 x 0 ... 10 V (≥ 5 kΩ) | DT50-N1124 | 1047617 |

¹⁾ Output Q short-circuit protected.

²⁾ Response time ≤ 15 ms.

³⁾ Wavelength: 658 nm; max. output: 180 mW; pulse length: 5 ns; pulse repetition rate: 1/200.

⁴⁾ Wavelength: 658 nm; max. output: 120 mW; pulse length: 2.5 ns; pulse repetition rate: 1/400.

⁵⁾ PNP: High = V_s (< 2.5 V); Low = 0 V.

⁶⁾ NPN: High = < 2.5 V; Low = V_s .

⁷⁾ PNP: High = V_s ; Low = ≤ 2.5 V.

⁸⁾ NPN: High = ≤ 2.5 V; Low = V_s .

Dimensional drawing

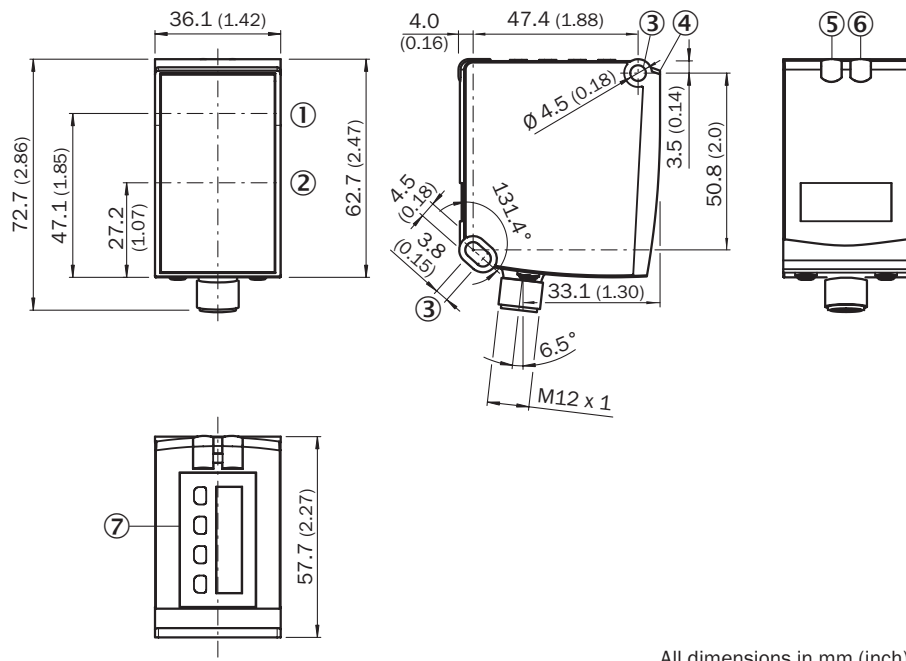

All dimensions in mm (inch)

- ① Optical axis sender
- ② Optical axis receiver
- ③ Mounting holes
- ④ Reference surface = 0 mm
- ⑤ Status indicator switching output (orange)
- ⑥ Status indicator power on (green)
- ⑦ Operating keys and display

Connection type and diagram

Connector M12, 5-pin

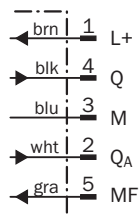
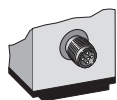

Compact size delivers exceptional performance up to 20 m

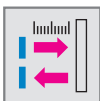
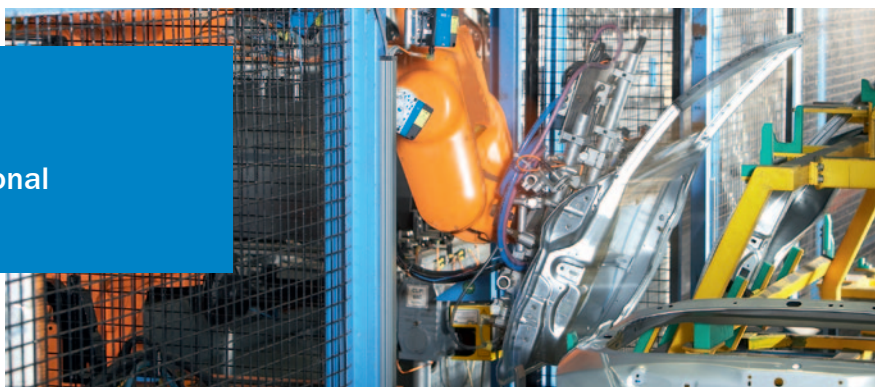

Product description

The compact DT50 Hi distance sensor offers superior precision. Compared to the DT50, the Hi version offers signifi-

cantly better precision. Additionally, the measurement range of this more powerful variant is twice as long.

At a glance

- HDDM technology provides the best reliability, immunity to ambient light and price/performance ratio
- Most compact sensor offering up to 20 m range directly on the object
- Amazing repeatability up to ± 1 mm
- Very fast measurement and output rate with 500 Hz
- Analog output with 4 ... 20 mA and 1 switching output
- Red laser light for precise alignment
- Tough metal housing with LC Display

Your benefits

- Improved production quality based on high precision and small black/white shift of the measurement
- The fast measurement frequency increases the production throughput
- Thanks to its compact housing size, the DT50 Hi offers precise measurement in applications with limited space
- Red light and an optional alignment bracket reduces installation time
- Intuitive setup via display or remote teach reduces installation time and costs
- Immune to any type of ambient light – allows for use in optically challenging environments
- Widest temperature range allows for outdoor use without additional cooling or heating accessories
- Metal housing withstands harsh environments, saving replacement costs



Laser class 1



Laser class 2



Additional information

Detailed technical data 13

Ordering information 14

Dimensional drawing 15

Connection type and diagram 15

Accessories 28

Detailed technical data

Features

| | |
|---|---|
| Measuring range 90 % remission | See type-specific data |
| Resolution | 1 mm |
| Repeatability 6 ... 90% remission ¹⁾ | 3 / 2 / 1 mm ²⁾ |
| Accuracy 90 % remission | ± 7 mm |
| Response time | 15 / 30 / 80 ms ²⁾ |
| Output rate | 2 ms |
| Typ. light spot size (distance) | 15 mm x 15 mm (10 m) |
| Additional features | <ul style="list-style-type: none"> • Set moving averaging: Fast/Medium/Slow • Switching mode: Distance to object (DtO) • Teach-in of switching output • Set switching output • Set hysteresis • Invertible switching output • Teach-in of analog output • Set analog output • Invertible analog output • Multi functional input: laser off, external teach, not active • Switch off display • Reset to factory default • Lock user interface |

¹⁾ Equivalent to 1 σ .

²⁾ Dependent on the set averaging: Fast / Medium / Slow.

Interfaces

| | |
|----------------------------|---------------------------------------|
| Outputs | See type-specific data |
| Analog outputs (max. load) | 1 x 4 ... 20 mA ($\leq 300 \Omega$) |
| Resolution analog outputs | 16 bit |
| Switching hysteresis | 10 ... 1,000 mm |
| Inputs | See type-specific data |

Mechanics/electronics

| | |
|------------------------------------|---|
| Supply voltage V_s ³⁾ | DC 10 ... 30 V |
| Ripple ⁴⁾ | $\leq 5 V_{SS}$ |
| Power consumption ⁵⁾ | $\leq 2.1 W$ |
| Initialization time | $\leq 250 ms$ |
| Warm up time | $\leq 15 min$ |
| Typ. weight without cable | 200 g |
| Housing material | Zinc-die cast (ZNAL4CU1)/Acrylic glass (PMMA) |
| Connection type | Connector M12, 5-pin |
| Indication | LC display 2 x LED |

³⁾ Limit values, reverse-polarity protected, operation in short circuit protected network, max. 8 A.

⁴⁾ May not exceed or fall short of V_s tolerances.

⁵⁾ Without load.

Ambient data

| | |
|--|--|
| Enclosure rating | IP 65 |
| Protection class | III |
| Ambient temperature | Operation: -30 ... +65 °C Storage: -40 ... +75 °C |
| Max. rel. humidity (not condensing) | ≤ 95 % |
| Typ. ambient light safety | 40 klx |
| Vibration resistance | EN 60068-2-6/-2-64 |
| Shock resistance | EN 60068-2-27/-2-29 |
| Average service life laser (MTTF at 25 °C) | 100,000 h |

Ordering information

| Light source | Measuring range (90/18/6 %) | Switching outputs (max. output current) ¹⁾ | Multi functional inputs ²⁾ | Model name | Part No. |
|--|--|---|---------------------------------------|------------|----------|
| Laser, red, Class 2 (EN 60825-1) ³⁾ | 200 ... 20,000 / 8,500 / 5,000 mm | 1 x PNP (100 mA) ⁵⁾ | 1 x PNP ⁷⁾ | DT50-P2113 | 1047314 |
| | | 1 x NPN (100 mA) ⁶⁾ | 1 x NPN ⁸⁾ | DT50-N2113 | 1047398 |
| Laser, red, Class 1 (EN 60825-1) ⁴⁾ | 200 ... 13,000 / 5,800 / 3,400 mm ² | 1 x PNP (100 mA) ⁵⁾ | 1 x PNP ⁷⁾ | DT50-P2123 | 1047399 |
| | | 1 x NPN (100 mA) ⁶⁾ | 1 x NPN ⁸⁾ | DT50-N2123 | 1047400 |

¹⁾ Output Q short-circuit protected.

²⁾ Response time ≤ 15 ms.

³⁾ Wavelength: 658 nm; max. output: 180 mW; pulse length: 5 ns; pulse repetition rate: 1/200.

⁴⁾ Wavelength: 658 nm; max. output: 120 mW; pulse length: 2.5 ns; pulse repetition rate: 1/400.

⁵⁾ PNP: High = V_s (< 2.5 V); Low = 0 V.

⁶⁾ NPN: High = < 2.5 V; Low = V_s .

⁷⁾ PNP: High = V_s , Low = ≤ 2.5 V.

⁸⁾ NPN: High = ≤ 2.5 V, Low = V_s .

Dimensional drawing

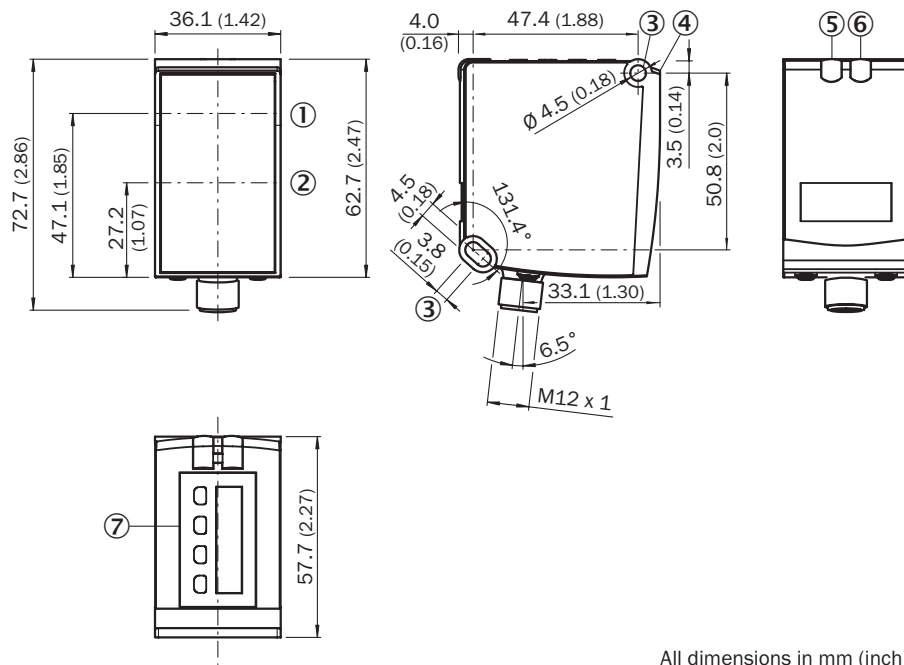

All dimensions in mm (inch)

- ① Optical axis sender
- ② Optical axis receiver
- ③ Mounting holes
- ④ Reference surface = 0 mm
- ⑤ Status indicator switching output (orange)
- ⑥ Status indicator power on (green)
- ⑦ Operating keys and display

Connection type and diagram

Connector M12, 5-pin

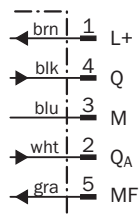
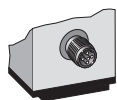

Precise detection from a distance of up to 10 m



Product description

The DS50 is a time-of-flight sensor that offers two switching outputs. With a range of up to 10 m, it allows reliable detection at a safe distance. Based on three different switching modes

(Distance to Object, Window or Object Between Sensor and Background), any material can easily be detected with the DS50.

At a glance

- HDDM technology provides the best reliability, immunity to ambient light and price/performance ratio
- Reliable detection up to 10 m
- High switching repeatability (± 2.5 mm)
- Two discrete outputs with up to 50 Hz switching frequency
- Three switching modes: “Distance to Object”, “Window” or “Object Between Sensor and Background” – detect any object
- Immune to cross talk for use with multiple sensors
- Superior background suppression

Your benefits

- Precise detection at a safe distance reduces scrap and increases throughput
- Immune to any type of ambient light – allows for use in optically challenging environments
- Widest temperature range allows for outdoor use without additional cooling or heating
- Intuitive setup via display or remote teach reduces installation time and costs
- Red light and an optional alignment bracket reduces installation time
- Metal housing withstands harsh environments, saving replacement costs
- Dx50 family is based on a common platform, which offers multiple performance levels, making it easy to accommodate future changes
- Low investment costs and high performance guarantee short return on investment

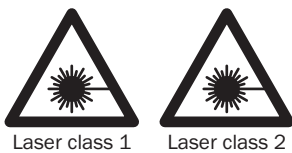

Additional information

Detailed technical data 17

Ordering information 18

Dimensional drawing 19

Connection type and diagram 19

Accessories 28

Detailed technical data

Features

| | |
|---|--|
| Measuring range 90 % remission | 200 ... 10,000 mm |
| Measuring range 18 % remission | 200 ... 6,000 mm |
| Measuring range 6 % remission | 200 ... 4,000 mm |
| Resolution ¹⁾ | 1 mm |
| Repeatability 6 ... 90% remission ²⁾ | 5/2.5 mm ³⁾ |
| Accuracy 90 % remission ¹⁾ | ± 10 mm |
| Typ. light spot size (distance) | 15 mm x 15 mm (10 m) |
| Additional features | <ul style="list-style-type: none"> • Set moving averaging: Fast/Slow • Switching mode: Distance to object (DtO), switching window (Wnd), Object between sensor and background (ObSB) • Teach-in of switching output • Set switching output • Set hysteresis • Invertible switching output • Multi functional input: laser off, external teach, not active • Unique measurement value • No cross talk • Switch off display • Reset to factory default • Lock user interface |

¹⁾ Related to distance value on the display.

²⁾ Equivalent to 1 σ .

³⁾ Dependent on the set averaging: Fast/Slow.

Interfaces

| | |
|----------------------|------------------------|
| Outputs | See type-specific data |
| Switching hysteresis | 1 ... 9,999 mm |
| Inputs | See type-specific data |

Mechanics/electronics

| | |
|------------------------------------|---|
| Supply voltage V_s ⁴⁾ | DC 10 ... 30 V |
| Ripple ⁵⁾ | $\leq 5 V_{ss}$ |
| Power consumption ⁶⁾ | ≤ 1.85 W |
| Initialization time | ≤ 350 ms |
| Warm up time | ≤ 15 min |
| Typ. weight without cable | 200 g |
| Housing material | Zinc-die cast (ZNAL4CU1)/Acrylic glass (PMMA) |
| Connection type | Connector M12, 5-pin |
| Indication | LC display 2 x LED |

⁴⁾ Limit values, reverse-polarity protected, operation in short circuit protected network, max. 8 A.

⁵⁾ May not exceed or fall short of V_s tolerances.

⁶⁾ Without load.

Ambient data

| | |
|--|--|
| Enclosure rating | IP 65 |
| Protection class | III |
| Ambient temperature | Operation: -30 ... +65 °C Storage: -40 ... +75 °C |
| Max. rel. humidity (not condensing) | ≤ 95 % |
| Typ. ambient light safety | 40 klx |
| Vibration resistance | EN 60068-2-6 / -2-64 |
| Shock resistance | EN 60068-2-27 / -2-29 |
| Average service life laser (MTTF at 25 °C) | 100,000 h |

Ordering information

| Measuring range (90/18/6 %) | Switching outputs (max. output current) ¹⁾ | Multi functional inputs ²⁾ | Light source | Switching frequency | Response time | Model name | Part No. |
|---|---|---------------------------------------|--|--------------------------|---------------------------|------------|----------|
| 200 ... 10,000 / 6,000 / 4,000 mm | 2 x PNP (100 mA) ⁴⁾ | 1 x PNP ⁶⁾ | Laser, red, Class 1 (EN 60825-1) ⁸⁾ | 25 / 5 Hz ³⁾ | 20 / 100 ms ³⁾ | DS50-P1122 | 1047405 |
| | | | Laser, red, Class 2 (EN 60825-1) ⁹⁾ | 50 / 10 Hz ³⁾ | 10 / 50 ms ³⁾ | DS50-P1112 | 1047402 |
| | 2 x NPN (100 mA) ⁵⁾ | 1 x NPN ⁷⁾ | Laser, red, Class 1 (EN 60825-1) ⁸⁾ | 25 / 5 Hz ³⁾ | 20 / 100 ms ³⁾ | DS50-N1122 | 1047406 |
| | | | Laser, red, Class 2 (EN 60825-1) ⁹⁾ | 50 / 10 Hz ³⁾ | 10 / 50 ms ³⁾ | DS50-N1112 | 1047404 |

¹⁾ Output Q short-circuit protected.

²⁾ Response time ≤ 60 ms.

³⁾ Dependent on the set averaging: Fast / Slow.

⁴⁾ PNP: High = V_s (< 2.5 V); Low = 0 V.

⁵⁾ NPN: High = < 2.5 V; Low = V_s .

⁶⁾ PNP: High = V_s , Low = ≤ 2.5 V.

⁷⁾ NPN: High = ≤ 2.5 V, Low = V_s .

⁸⁾ Wavelength: 658 nm; max. output: 120 mW; pulse duration: 5 ns; pulse repetition rate: 1/400.

⁹⁾ Wavelength: 658 nm; max. output: 180 mW; pulse duration: 5 ns; pulse repetition rate: 1/200.

Looking ahead – up to 50 m on reflector



Laser class 1



Additional information

| | |
|-----------------------------------|----|
| Detailed technical data | 21 |
| Ordering information | 22 |
| Dimensional drawing | 23 |
| Connection type and diagram | 23 |
| Accessories | 28 |

Product description

The DL50 is the ideal solution for positioning tasks. Using a switching and an analog output, distance control can be

easily implemented. Apart from a measurement range of 50 m, the sensor also offers a high level of precision.

At a glance

- HDDM technology provides the best reliability, immunity to ambient light and price/performance ratio
- Up to 50 m range on diamond grade reflector
- Very good repeatability for positioning tasks – up to ± 2 mm
- Fast measurement and output rate with 250 Hz
- Analog output with 4 ... 20 mA and 1 switching output
- Red laser light for precise alignment
- Wide operating temperature range from -30 °C to $+65$ °C

Your benefits

- A wide measurement range, analog and switching output create an easy, fast and flexible solution for any positioning task
- Red light and an optional alignment bracket reduces installation time
- Intuitive setup via display or remote teach reduces installation time and costs
- Widest temperature range allows for outdoor use without additional cooling or heating accessories
- Immune to any type of ambient light – allows for use in optically challenging environments
- Metal housing withstands harsh environments, saving replacement costs
- Low investment costs and high performance guarantee quick return on investment
- Dx50 family is based on a common platform, which offers multiple performance levels, making it easy to accommodate future changes

Detailed technical data

Features

| | |
|---|--|
| Measuring range (reflector type) | 200 ... 50,000 mm (Diamond Grade) |
| Resolution | 1 mm |
| Repeatability (on reflector type) ¹⁾ | 3 / 2 mm ²⁾ |
| Accuracy (on reflector type) | ± 7 mm |
| Response time | 15 / 30 ms ²⁾ |
| Output rate | 4 ms |
| Typ. light spot size (distance) | 15 mm x 15 mm (10 m) |
| Additional features | <ul style="list-style-type: none"> • Set moving averaging: Fast/Slow • Switching mode: Distance to object (DtO) • Teach-in of switching output • Set switching output • Set hysteresis • Invertible switching output • Teach-in of analog output • Set analog output • Invertible analog output • Multi functional input: laser off, external teach, not active • Switch off display • Reset to factory default • Lock user interface |

¹⁾ Equivalent to 1 σ .

²⁾ Dependent on the set averaging: Fast/Slow.

Interfaces

| | |
|----------------------------|---------------------------------------|
| Outputs | See type-specific data |
| Analog outputs (max. load) | 1 x 4 ... 20 mA ($\leq 300 \Omega$) |
| Resolution analog outputs | 16 bit |
| Switching hysteresis | 10 ... 1,000 mm |
| Inputs | See type-specific data |

Mechanics/electronics

| | |
|------------------------------------|---|
| Supply voltage V_s ³⁾ | DC 10 ... 30 V |
| Ripple ⁴⁾ | $\leq 5 V_{SS}$ |
| Power consumption ⁵⁾ | $\leq 2.1 W$ |
| Initialization time | $\leq 250 ms$ |
| Warm up time | $\leq 15 min$ |
| Typ. weight without cable | 200 g |
| Housing material | Zinc-die cast (ZNAL4CU1)/Acrylic glass (PMMA) |
| Connection type | Connector M12, 5-pin |
| Indication | LC display 2 x LED |

³⁾ Limit values, reverse-polarity protected, operation in short circuit protected network, max. 8 A.

⁴⁾ May not exceed or fall short of V_s tolerances.

⁵⁾ Without load.

Ambient data

| | |
|--|--|
| Enclosure rating | IP 65 |
| Protection class | III |
| Ambient temperature | Operation: -30 ... +65 °C Storage: -40 ... +75 °C |
| Max. rel. humidity (not condensing) | ≤ 95 % |
| Typ. ambient light safety | 40 klx |
| Vibration resistance | EN 60068-2-6/-2-64 |
| Shock resistance | EN 60068-2-27/-2-29 |
| Average service life laser (MTTF at 25 °C) | 100,000 h |

Ordering information

| Light source | Measuring range (on Diamond Grade) | Switching outputs (max. output cur- rent) ¹⁾ | Multi functional inputs ²⁾ | Analog outputs (max./min. load) | Model name | Part No. |
|---|--|---|--|------------------------------------|------------|----------|
| Laser, red, Class 1 (EN 60825-1) ³⁾ | 200 ... 50,000 mm | 1 x PNP (100 mA) ⁴⁾ | 1 x PNP ⁶⁾ | 1 x 4 ... 20 mA (≤ 300 Ω) | DL50-P1123 | 1047361 |
| | | 1 x NPN (100 mA) ⁵⁾ | 1 x NPN ⁷⁾ | 1 x 4 ... 20 mA (≤ 300 Ω) | DL50-N1123 | 1047401 |

¹⁾ Output Q short-circuit protected.

²⁾ Response time ≤ 15 ms.

³⁾ Wavelength: 658 nm; max. output: 120 mW; pulse length: 2.5 ns; pulse repetition rate: 1/400.

⁴⁾ PNP: High = $V_s - (< 2.5 \text{ V})$; Low = 0 V.

⁵⁾ NPN: High = $< 2.5 \text{ V}$; Low = V_s .

⁶⁾ PNP: High = V_s ; Low = $\leq 2.5 \text{ V}$.

⁷⁾ NPN: High = $\leq 2.5 \text{ V}$; Low = V_s .

Dimensional drawing

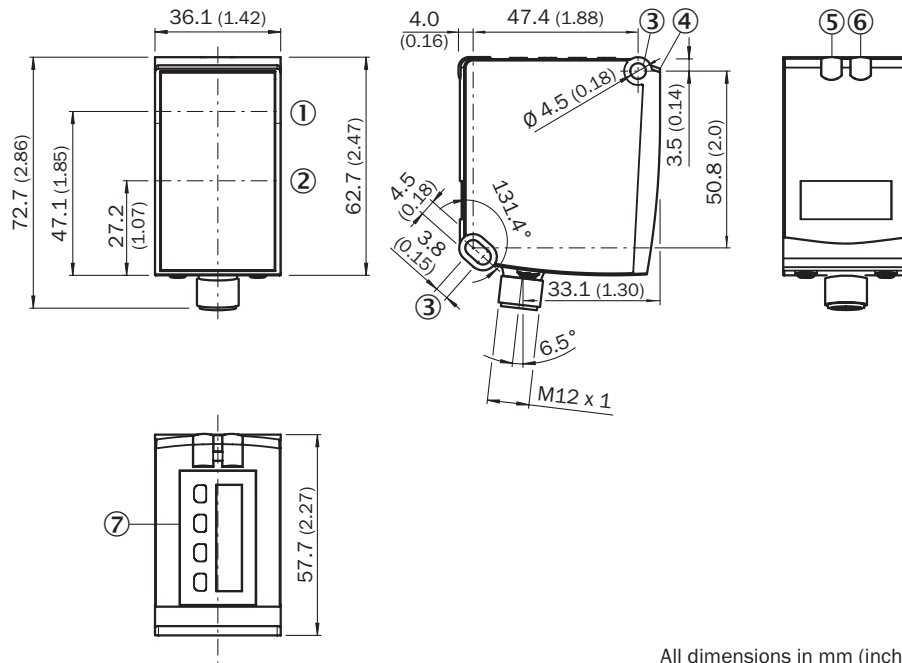

All dimensions in mm (inch)

- ① Optical axis sender
- ② Optical axis receiver
- ③ Mounting holes
- ④ Reference surface = 0 mm
- ⑤ Status indicator switching output (orange)
- ⑥ Status indicator power on (green)
- ⑦ Operating keys and display

Connection type and diagram

Connector M12, 5-pin

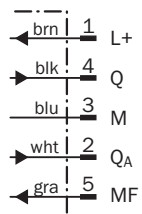
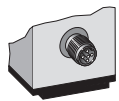

Large positioning performance.
Small housing.

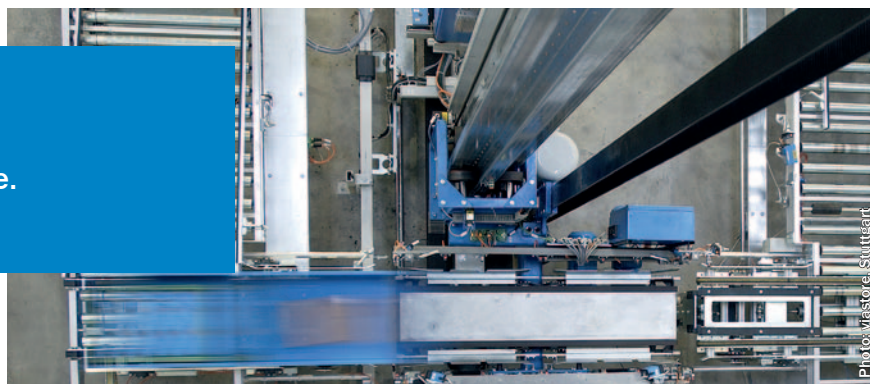
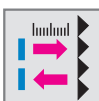

Photo: Mestor, Stuttgart



Product description

The DL50 Hi is the world's smallest sensor for high-precision positioning. Due to its reflector-based measurement, incred-

ibly high repeatability is achieved. In order to avoid any loss of precision, the data is provided via serial interface.

At a glance

- HDDM technology provides the best reliability, immunity to ambient light and price/performance ratio
- Up to 50 m range on diamond grade reflector
- World's smallest sensor for high precision positioning
- Highest repeatability in its class, with $\leq \pm 0.5$ mm
- Fast RS-422 output rate – measurement value every 2.5 ms
- Immune to cross talk for use with multiple sensors
- Superior background suppression

Your benefits

- Precise positioning enables greater speed and accuracy, which increases throughput
- Highest performance at reasonable investment costs guarantee a short return on investment
- Immune to any type of ambient light - allows for use in optically challenging environments
- Widest temperature range allows for outdoor use without additional cooling or heating accessories
- Intuitive setup via display or remote teach reduces installation time and costs
- Red light and an optional alignment bracket reduces installation time
- Metal housing withstands harsh environments, saving replacement costs
- World's smallest sensor for high precision positioning for use in applications with limited space



Laser class 1

RS422



CDRH

Additional information

| | |
|-----------------------------------|----|
| Detailed technical data | 25 |
| Ordering information | 26 |
| Dimensional drawing | 27 |
| Connection type and diagram | 27 |
| Accessories | 28 |

Detailed technical data

Features

| | |
|----------------------------------|--|
| Measuring range (reflector type) | 200 ... 50,000 mm (Diamond Grade) |
| Resolution | 0.1 mm |
| Typ. repeatability ¹⁾ | 0.5 / 0.3 / 0.25 mm ²⁾ |
| Accuracy | ± 3 mm ³⁾ |
| Response time | 10 / 40 / 160 ms ²⁾ |
| Output rate | 2.5 ms ⁴⁾ |
| Typ. light spot size (distance) | 15 mm x 15 mm (10 m) |
| Additional features | <ul style="list-style-type: none"> • Set moving averaging: Fast/Medium/Slow • Switching mode: Distance to object (DtO) • Teach-in of switching points • Set switching outputs • Set hysteresis • Invertible switching output • Multi functional input: laser off, external teach, switching output 2, not active • Serial data output: continuous, on request • Set baud rate: 19,200, 38,400, 57,600, 115,200 bps • Set parity check: none; even; odd • Unique measurement value • No cross talk • Switch off display • Reset to factory default • Lock user interface |

¹⁾ Equivalent to 1 σ .

²⁾ Dependent on the set averaging: Fast/Medium/Slow.

³⁾ May reach up to ± 5 mm at limiting measuring range.

⁴⁾ For baud rate 115,200 bps.

Interfaces

| | |
|----------------------|------------------------|
| Outputs | See type-specific data |
| Switching hysteresis | 1 ... 1,000 mm |
| Inputs | See type-specific data |
| Data interface | RS-422 |

Mechanics/electronics

| | |
|------------------------------------|---|
| Supply voltage V_s ⁵⁾ | DC 10 ... 30 V |
| Ripple ⁶⁾ | ≤ 5 V_{ss} |
| Power consumption ⁷⁾ | ≤ 2.1 W |
| Initialization time | ≤ 250 ms |
| Warm up time | ≤ 15 min |
| Typ. weight without cable | 200 g |
| Housing material | Zinc-die cast (ZNAL4CU1)/Acrylic glass (PMMA) |
| Connection type | Connector M12, 8-pin |
| Indication | LC display 2 x LED |

⁵⁾ Limit values, reverse-polarity protected, operation in short circuit protected network, max. 8 A.

⁶⁾ May not exceed or fall short of V_s tolerances.

⁷⁾ Without load.

Ambient data

| | |
|--|--|
| Enclosure rating | IP 65 |
| Protection class | III |
| Ambient temperature | Operation: -30 ... +65 °C Storage: -40 ... +75 °C |
| Max. rel. humidity (not condensing) | ≤ 95 % |
| Typ. ambient light safety | 40 klx |
| Vibration resistance | EN 60068-2-6/-2-64 |
| Shock resistance | EN 60068-2-27/-2-29 |
| Average service life laser (MTTF at 25 °C) | 100,000 h |

Ordering information

| Light source | Measuring range (on Diamond Grade) | Switching outputs (max. output cur- rent) ³⁾ | Multi functional inputs ⁴⁾ | Data interface | Model name | Part No. |
|---|--|---|--|----------------|------------|----------|
| Laser, red, Class 1 (EN 60825-1) ⁵⁾ | 200 ... 50,000 mm | 2 x /1 x PNP (100 mA) ^{6) 7)} | -/1 x PNP ^{6) 9)} | RS-422 | DL50-P2225 | 1048418 |
| | | 2 x /1 x NPN (100 mA) ^{6) 8)} | -/1 x NPN ^{6) 10)} | RS-422 | DL50-N2225 | 1048419 |

³⁾ Output Q short-circuit protected.

⁴⁾ Response time ≤ 60 ms.

⁵⁾ Wavelength: 658 nm; max. output: 80 mW; pulse length: 2.5 ns; pulse repetition rate: 1/240.

⁶⁾ Dependent on the set function MF: switching output 2 / laser off, external teach.

⁷⁾ PNP: High = V_s (< 2.5 V); Low = 0 V.

⁸⁾ NPN: High = < 2.5 V; Low = V_s .

⁹⁾ PNP: High = V_s , Low = ≤ 2.5 V.

¹⁰⁾ NPN: High = ≤ 2.5 V, Low = V_s .

Dimensional drawing

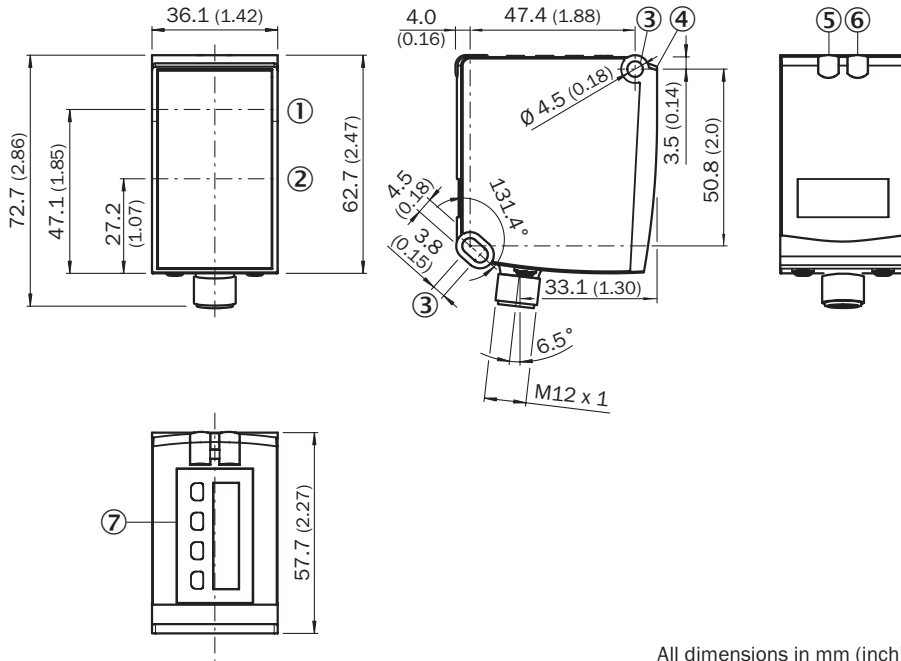

All dimensions in mm (inch)

- ① Optical axis sender
- ② Optical axis receiver
- ③ Mounting holes
- ④ Reference surface = 0 mm
- ⑤ Status indicator switching output Q₁ (orange)
- ⑥ Status indicator switching output Q₂ (orange)
- ⑦ Operating keys and display

Connection type and diagram

Connector
M12, 8-pin

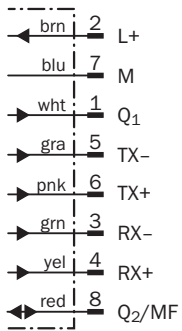
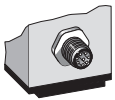

Cables and connectors

Connectors M12, 5-pin

| Connector type | Enclosure rating | Cable alignment | Sheath material | Cable length | Model name | Part No. | |
|------------------|------------------|--------------------------|-----------------|----------------|----------------|-----------------|---------|
| Female connector | IP 68 | Straight | PVC | 2 m | DOL-1205-G02M | 6008899 | |
| | | | | 5 m | DOL-1205-G05M | 6009868 | |
| | | | | 10 m | DOL-1205-G10M | 6010544 | |
| | | | | 15 m | DOL-1205-G15M | 6029215 | |
| | | | | 2 m | DOL-1205-G02MC | 6025906 | |
| | | PUR halogen-free | 5 m | DOL-1205-G05MC | 6025907 | | |
| | | | 10 m | DOL-1205-G10MC | 6025908 | | |
| | | | Angled | PVC | 2 m | DOL-1205-W02M | 6008900 |
| | | | | | 5 m | DOL-1205-W05M | 6009869 |
| | | | | | 10 m | DOL-1205-W10M | 6010542 |
| | PUR halogen-free | 2 m | DOL-1205-W02MC | 6025909 | | | |
| | | 5 m | DOL-1205-W05MC | 6025910 | | | |
| | | 10 m | DOL-1205-W10MC | 6025911 | | | |
| | | IP 67 IP 68 IP 69K | Straight | Shielded, PUR | 5 m | DOL-1205-G05MAC | 6036384 |
| 10 m | DOL-1205-G10MAC | | | | 6036385 | | |
| 20 m | DOL-1205-G20MAC | | | | 6036386 | | |
| IP 67 | Straight | - | - | DOS-1205-G | 6009719 | | |
| | | | Angled | - | DOS-1205-W | 6009720 | |
| Male connector | IP 67 | Straight | - | - | STE-1205-G | 6022083 | |
| | | Angled | - | - | STE-1205-W | 6022082 | |

DOL-1205-G02M
DOL-1205-G05M

DOL-1205-G10M
DOL-1205-G15M

DOL-1205-G02MC
DOL-1205-G05MC
DOL-1205-G10MC

DOL-1205-G05MAC
DOL-1205-G10MAC
DOL-1205-G20MAC

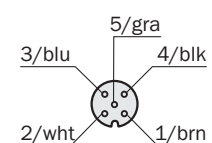
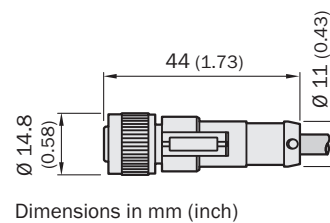
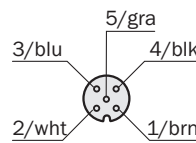
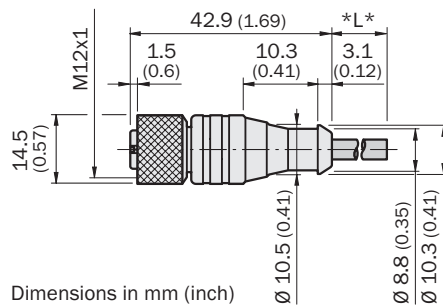

Dimensions in mm (inch)

Dimensions in mm (inch)

DOL-1205-W02M
DOL-1205-W05M

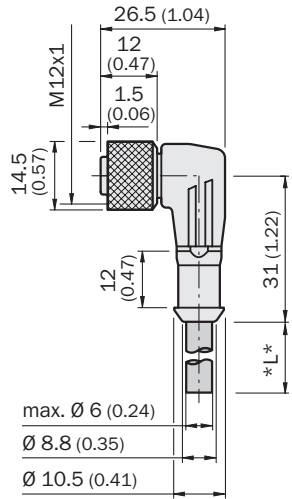

DOL-1205-W10M

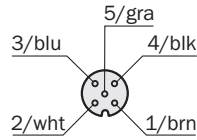

Dimensions in mm (inch)

DOL-1205-W02MC
DOL-1205-W05MC

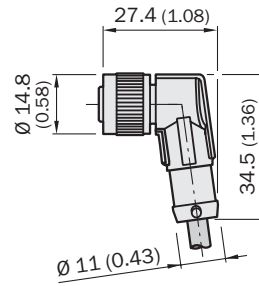

DOL-1205-W10MC

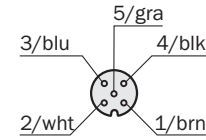

Dimensions in mm (inch)

DOS-1205-G

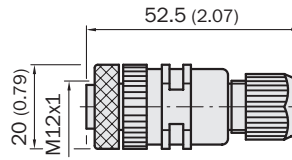

Dimensions in mm (inch)

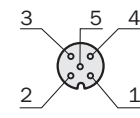

cable diameter
3 to 6.5 mm
(0.12 to 0.26)

DOS-1205-W

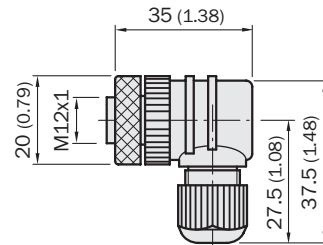

Dimensions in mm (inch)

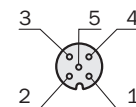

cable diameter
3 to 6.5 mm
(0.12 to 0.26)

STE-1205-G

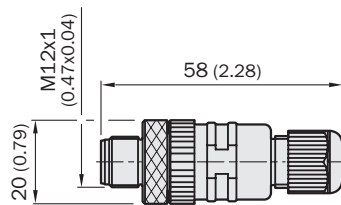

Dimensions in mm (inch)

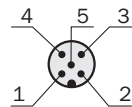

cable diameter
3 to 6.5 mm

STE-1205-W

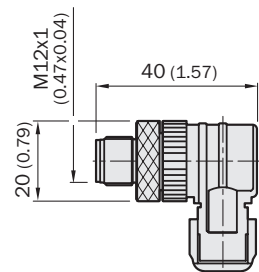

Dimensions in mm (inch)

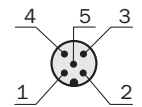

cable diameter
3 to 6.5 mm

Connectors M12, 8-pin

| Connector type | Enclosure rating | Cable alignment | Sheath material | Cable length | Model name | Part No. |
|------------------|------------------|-----------------|-----------------|--------------|----------------|----------|
| Female connector | IP 67 | Straight | Shielded, PVC | 2 m | DOL-1208-G02MA | 6020633 |
| | | | | 5 m | DOL-1208-G05MA | 6020993 |
| | | | | 10 m | DOL-1208-G10MA | 6022152 |
| | | | | 15 m | DOL-1208-G15MA | 6022153 |
| | | | | 30 m | DOL-1208-G30MA | 6022242 |
| Male connector | IP 67 | Straight | CuZn, shielded | 2 m | DOL-1208-W02MA | 6020992 |
| | | | | 5 m | DOL-1208-W05MA | 6021033 |
| | | | | - | DOS-1208-GA | 6028369 |
| | | | CuZn, shielded | - | STE-1208-GA | 6028370 |

DOL-1208-G02MA
DOL-1208-G05MA
DOL-1208-G10MA
DOL-1208-G15MA
DOL-1208-G30MA

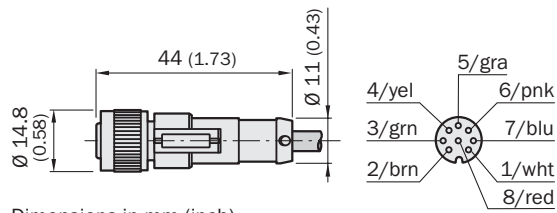

Dimensions in mm (inch)

DOL-1208-W02MA
DOL-1208-W05MA

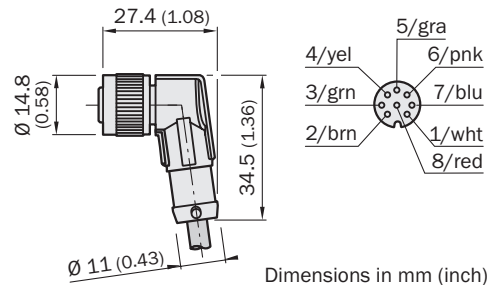

Dimensions in mm (inch)

DOS-1208-GA

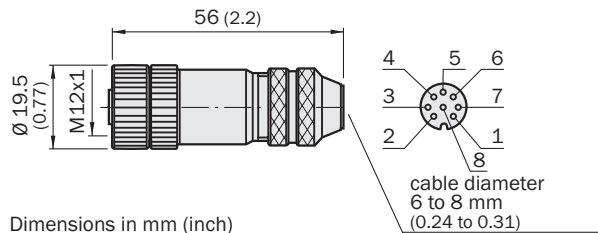

Dimensions in mm (inch)

STE-1208-GA

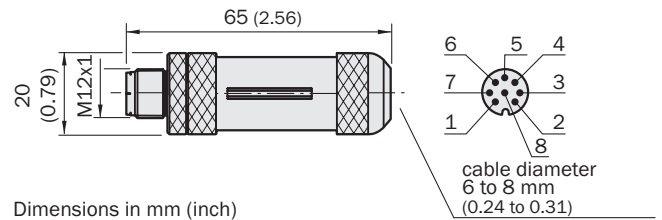

Dimensions in mm (inch)

Mounting systems

| Mounting type | Description | Model name | Part No. |
|--------------------------------|--|--------------|----------|
| Mounting bracket | Dx50 mounting bracket | BEF-WN-DX50 | 2048370 |
| | Mounting bracket for weather-protection hood | BEF-WN-OBW | 2023251 |
| Clamping and alignment bracket | Dx50 alignment bracket, zinc plated steel | BEF-AH-DX50 | 2048397 |
| Universal bar clamp system | Plate N for universal bar clamp, stainless steel | BEF-KHS-N03N | 2051619 |
| | Plate N for universal bar clamp | BEF-KHS-N03 | 2051609 |
| | Universal bar clamp | BEF-KHS-KH1 | 2022726 |
| | Mounting rod straight | BEF-MS12G-A | 4056054 |
| | | BEF-MS12G-B | 4056055 |
| | Mounting rod L-shaped | BEF-MS12L-A | 4056052 |
| | | BEF-MS12L-B | 4056053 |
| Mounting rod Z-shaped | BEF-MS12Z-A | 4056056 | |
| | BEF-MS12Z-B | 4056057 | |
| Rod mounting clamp | BEF-RMC-D12 | 5321878 | |

BEF-WN-DX50

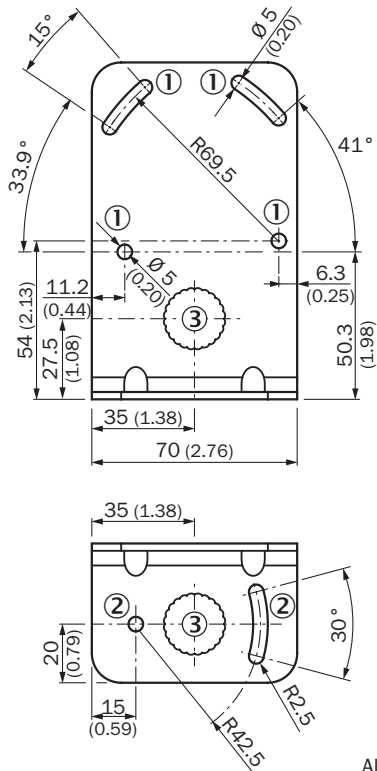

All dimensions in mm (inch)

- ① Mounting hole sensor
- ② Mounting hole bracket
- ③ Universal bar clamp mounting

BEF-WN-OBW

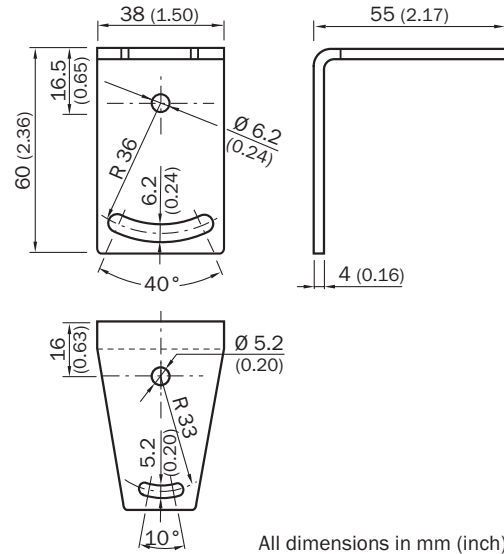

All dimensions in mm (inch)

BEF-AH-DX50

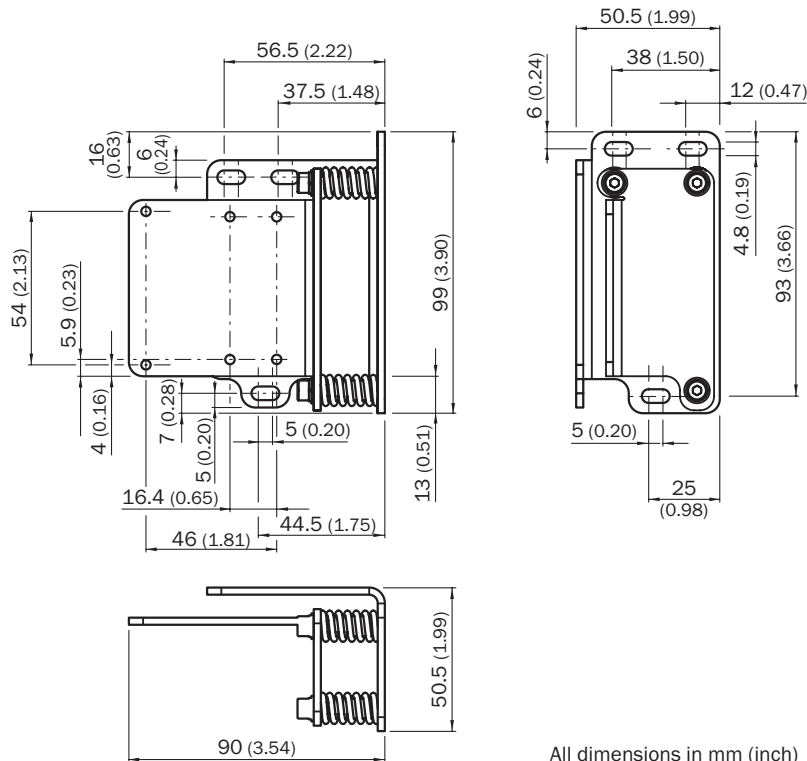

All dimensions in mm (inch)

BEF-KHS-N03N
BEF-KHS-N03

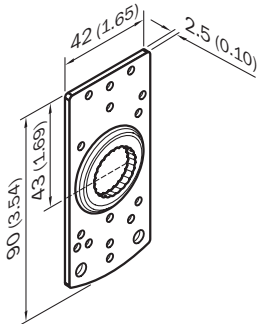

All dimensions in mm (inch)

BEF-MS12G-A
BEF-MS12G-B

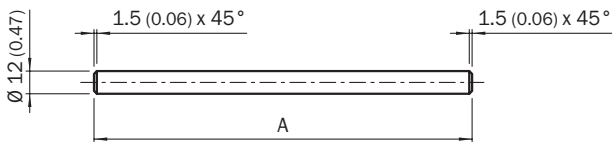

All dimensions in mm (inch)

BEF-MS12Z-A
BEF-MS12Z-B

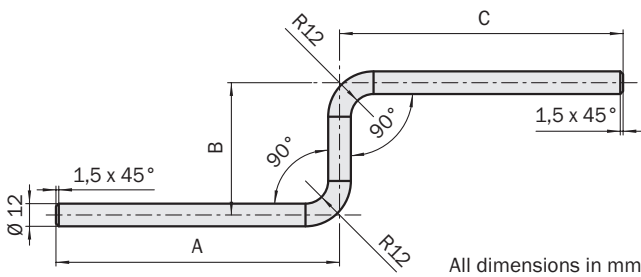

All dimensions in mm

BEF-KHS-KH1

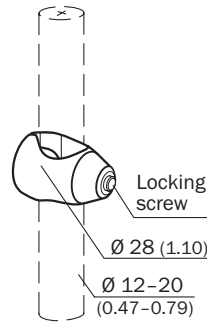

All dimensions in mm (inch)

BEF-MS12L-A
BEF-MS12L-B

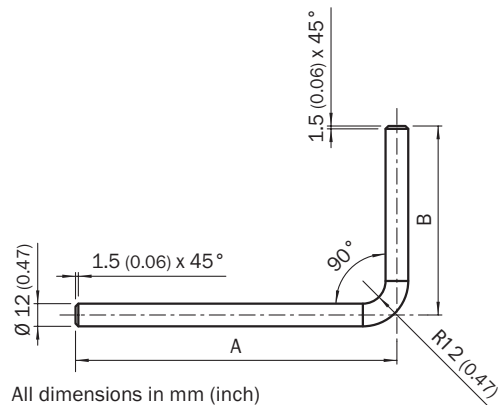

All dimensions in mm (inch)

BEF-RMC-D12

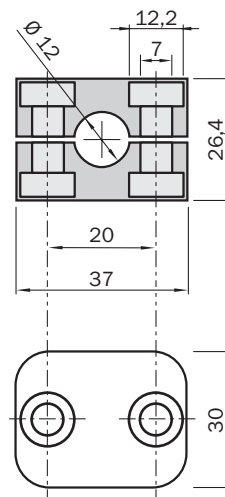

All dimensions in mm

Weather protection

| Description | Model name | Part No. |
|-------------------------|-------------|----------|
| Weather protection hood | OBW-KHS-M02 | 2050205 |

OBW-KHS-M02

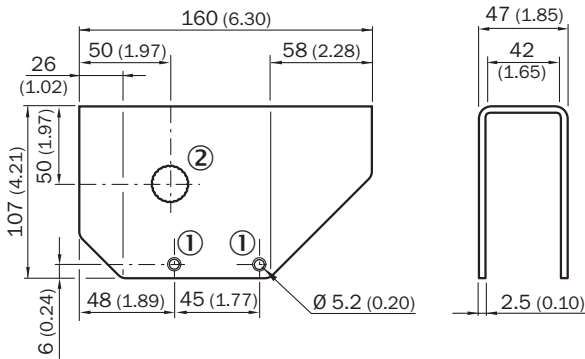

All dimensions in mm (inch)

- ① Mounting hole sensor (included in scope of supply)
- ② Universal bar clamp mounting

Reflectors

| Dimensions (L x W) | Model name | Part No. |
|---|------------|----------|
| Pre-mounted 330 mm x 330 mm | PL240DG | 1017910 |
| Pre-mounted 665 mm x 665 mm | PL560DG | 1016806 |
| Pre-mounted with heating 330 mm x 330 mm | PL240DG-H | 1022926 |
| Pre-mounted with heating 665 mm x 665 mm | PL560DG-H | 1023888 |
| Diamond Grade reflector foil, adjusted to customer requirements | REF-DG-K | 4019634 |
| Diamond Grade reflector foil, 749 mm x 914 mm | REF-DG | 5320565 |

PL240DG

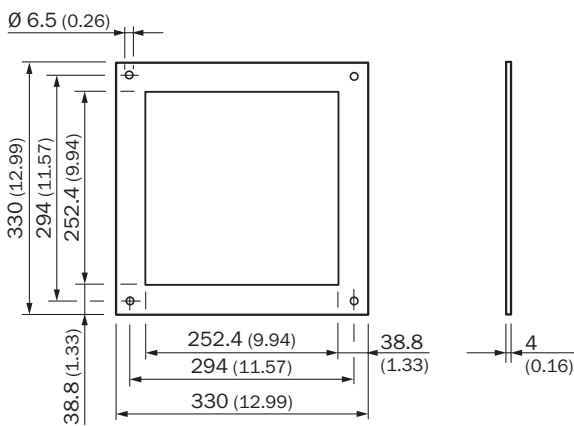

All dimensions in mm (inch)

PL560DG

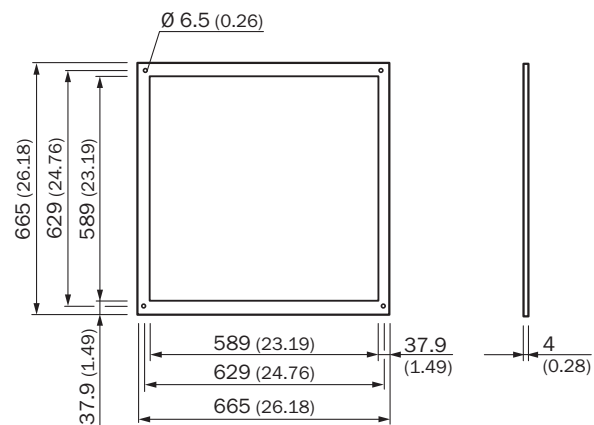

All dimensions in mm (inch)

Cooling accessories

| Description | Model name | Part No. |
|-----------------------------|------------------|----------|
| Cooling plate | BEF-KP-DX50/DT20 | 2055755 |
| Front heat protection cover | - | 2057137 |

BEF-KP-DX50/DT20

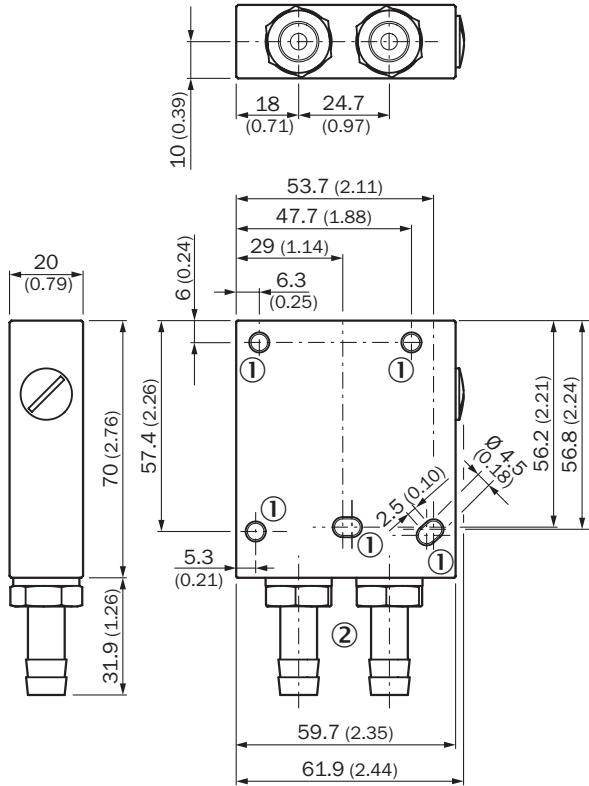

All dimensions in mm (inch)

- ① Mounting hole sensor
- ② Hose nozzle R1/4"

Front heat protection cover

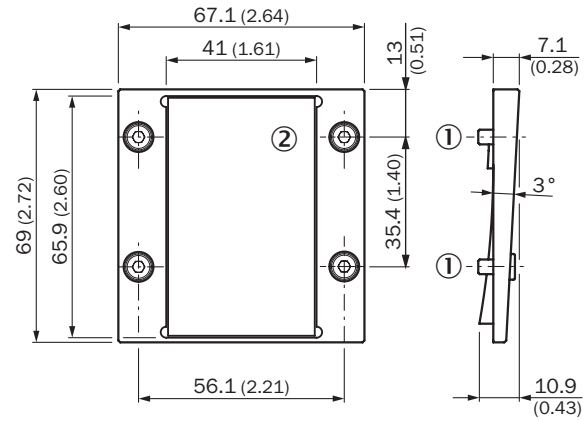

All dimensions in mm (inch)

- ① Mounting hole front heat protection cover
- ② Protective glass

Worldwide presence with subsidiaries in the following countries:

Australia
Belgium/Luxembourg
Brasil
Česká Republika
China
Danmark
Deutschland
España
France
Great Britain
India
Israel
Italia
Japan
Nederland
Norge

Österreich
Polska
Republic of Korea
Republika Slovenija
România
Russia
Schweiz
Singapore
Suomi
Sverige
Taiwan
Türkiye
United Arab Emirates
USA/Canada/México

Please find detailed addresses and additional representatives and agencies in all major industrial nations at www.sick.com

Handed over by:

Our Business Segment Expertise

Factory automation

With its intelligent sensors, safety systems, and automatic identification applications, SICK provides comprehensive solutions for factory automation.



- Non-contact detecting, counting, classifying, and positioning of any type of object
- Accident protection and personal safety using sensors, as well as safety software and services

Logistics automation

Sensors made by SICK form the basis for automating material flows and the optimization of sorting and warehousing processes.



- Automated identification with barcode and RFID reading devices for the purpose of sorting and target control in industrial material flow
- Detecting volume, position, and contours of objects and surroundings with laser measurement systems

Process automation

Optimized system solutions from SICK ensure efficient acquisition of environmental and process data in many industrial processes.



- Precise measurement of gases, liquids and dust concentrations for continuous monitoring of emissions and the acquisition of process data in production processes
- Gas flow measurements with maximum accuracy thanks to compact gas meters